

Travel directions

Copenhagen Airport to Hotel Scandic Falkoner

When you arrive at Copenhagen Airport, you will need to find your way to Hotel Scandic Falkoner. The address of the hotel is Falkoner Alle 9, 2000 Frederiksberg. To get to the hotel, you can take the metro directly from the airport to Frederiksberg Metro Station.

The metro station is located by terminal 3 in the airport. The metro will get you to Frederiksberg metro station in about 20 minutes. Tickets can be bought at the vending machines (which take all major credit cards) and at the DSB ticket sales counter in terminal 3. Single tickets: 30 DKK (for 1 trip in 3 zones, i.e. from the airport to the hotel).

Taxis can pick up passengers at terminal 3, the arrival terminal, and will get you to Frederiksberg in about 30-35 minutes depending on traffic. The taxi ride typically costs approximately 400-500 DKK.

Please find a map of the Metro below.

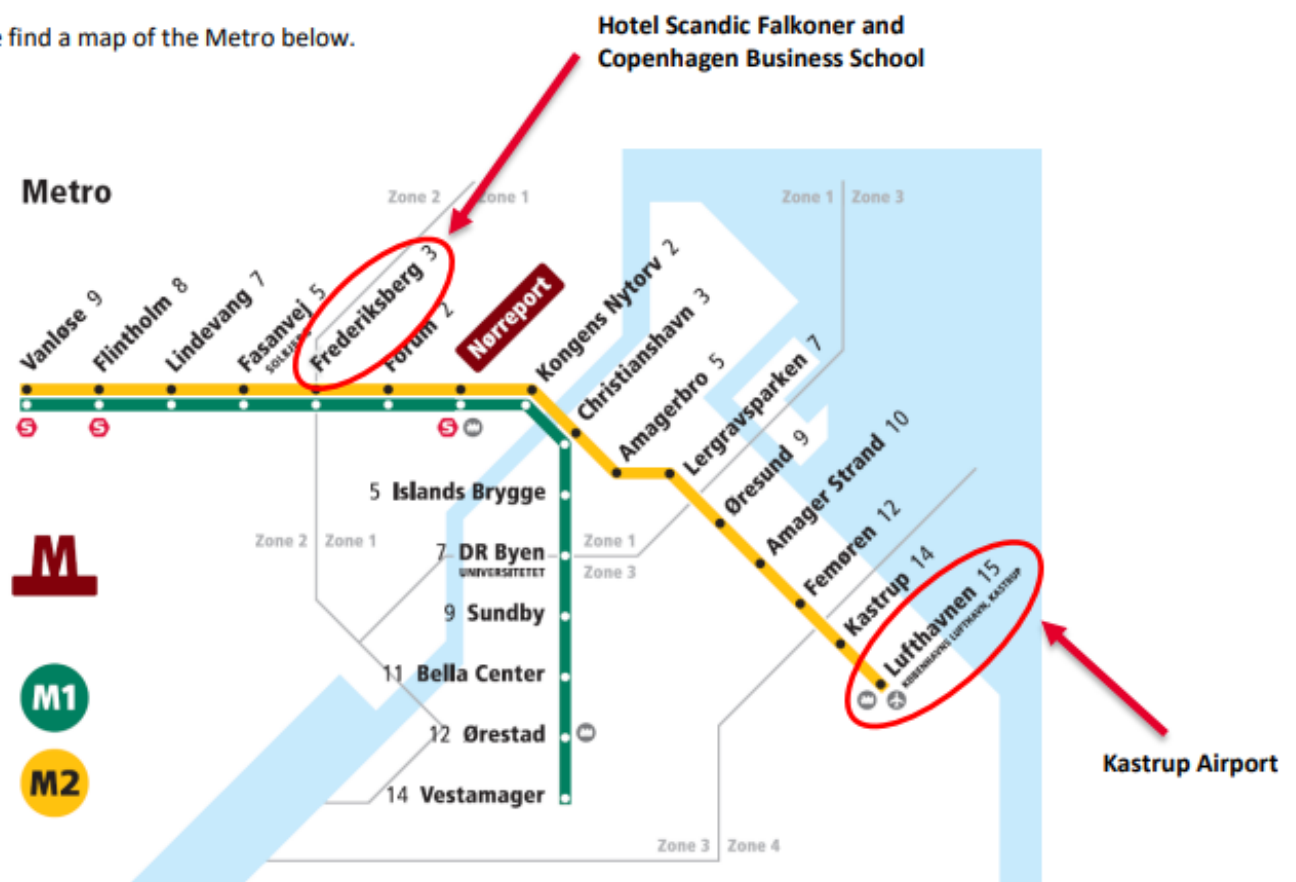

Frederiksberg Metro to Hotel Scandic Falkoner

When you arrive at Frederiksberg Metro Station, you need to find your way to Hotel Scandic Falkoner. The hotel Scandic Falkoner is a 3 min. walk (240 m) from Frederiksberg metro station. You can follow the route shown on the map below.



Hotel Scandic Falkoner to Copenhagen Business School (CBS)

Copenhagen Business School is located at Solbjerg Plads 3, 2000 Frederiksberg, next to the metro station. See below.

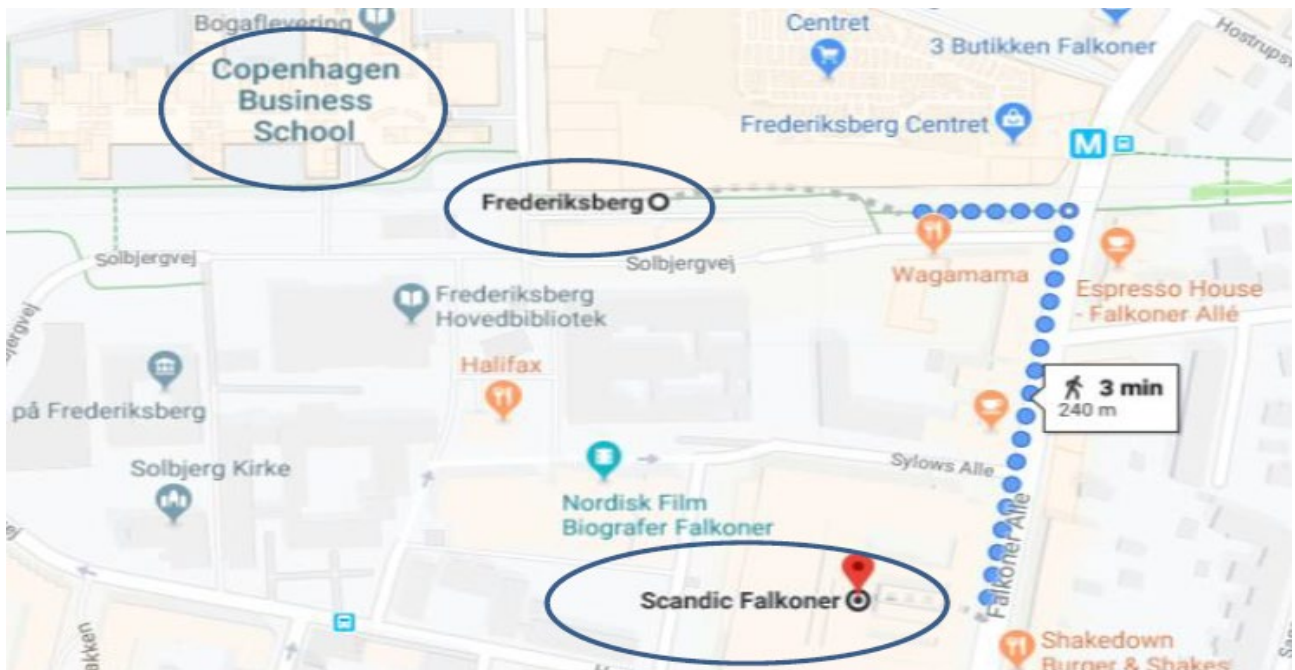

Finding the workshop room at Copenhagen Business School

The workshop will take place in **room SP113** at Copenhagen Business School, located at **Solbjerg Plads 3, 2000 Frederiksberg**.

You can enter the building through any of the three main entrances. Once inside, go up to the first floor to find the room. There will be signs posted in the building to help guide you to the correct location. Please also refer to the map below for directions.

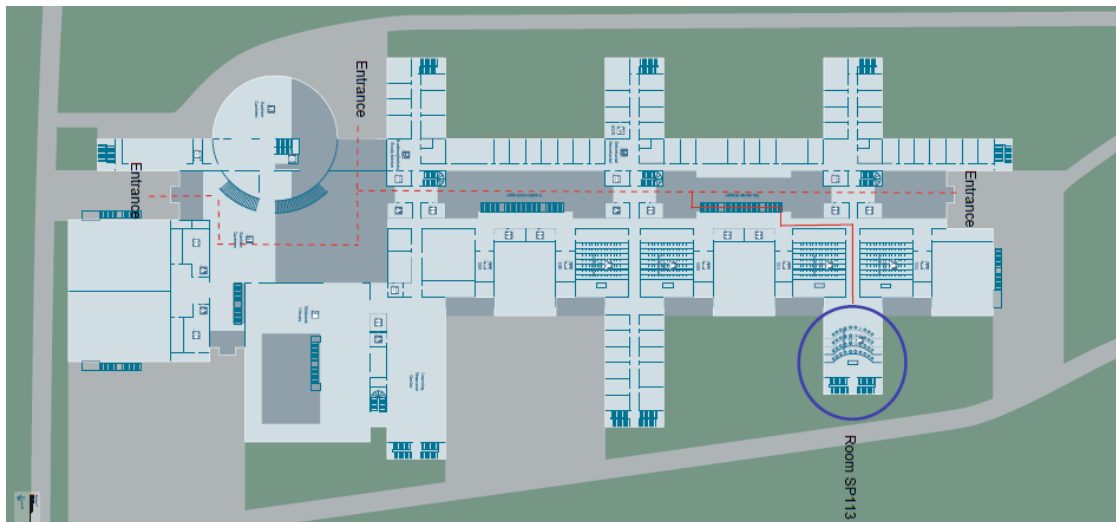

From Hotel Scandic Falkoner to Home of Carlsberg and Restaurant Madklubben in Carlsberg Byen.
Address: Gamle Carlsberg Vej 11

To get from Hotel Scandic Falkoner to Home of Carlsberg and Restaurant Madklubben, you have two options:

- **By bus:** Take bus 18 from outside Frederiksberg Centret on Falkoner Allé. Ride for 5 stops (approx. 16 minutes).
- **By foot:** Walking takes approximately 30 minutes.

You can **buy a ticket:**

- Directly from the bus driver (cash only), or
- Via your phone using the DOT Mobilbilletter or DSB app. Enter your destination or select the required number of zones (2 zones), then pay by card. The tickets costs around 24 DKK.

